

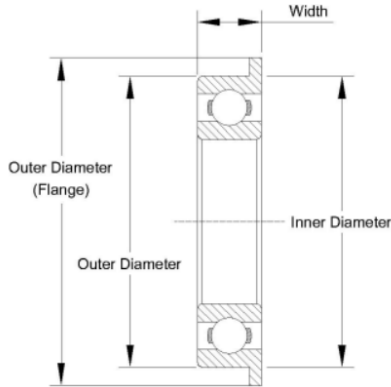

FR Series Flanged Miniature Bearings



Part Number	Bore diameter	Outside diameter	Width	Flange outer diameter	Flange thickness	Seal type	Ring material	Ball material	Limiting speed
FR0	0.046875"	0.15625"	0.0625"	0.203"	0.013"	Open	Chrome Steel	Chrome Steel	110 X 1000 rpm
FR0zz	0.046875"	0.15625"	0.0937"	0.203"	0.031"	Shielded	Chrome Steel	Chrome Steel	110 X 1000 rpm
FR1	0.05556"	0.1875"	0.0781"	0.234"	0.023"	Open	Chrome Steel	Chrome Steel	90 X 1000 rpm
FR1zz	0.05556"	0.1875"	0.1094"	0.234"	0.031"	Shielded	Chrome Steel	Chrome Steel	90 X 1000 rpm
FR1-4	0.07813"	0.25"	0.0937"	0.296"	0.023"	Open	Chrome Steel	Chrome Steel	67 X 1000 rpm
FR1-4 2rs	0.07813"	0.25"	0.1406"	0.296"	0.031"	Sealed	Chrome Steel	Chrome Steel	67 X 1000 rpm
FR1-4zz	0.07813"	0.25"	0.1406"	0.296"	0.031"	Shielded	Chrome Steel	Chrome Steel	67 X 1000 rpm
FR133	0.09375"	0.1875"	0.0625"	0.234"	0.018"	Open	Chrome Steel	Chrome Steel	80 X 1000 rpm
FR133 2rs	0.09375"	0.1875"	0.0937"	0.234"	0.031"	Sealed	Chrome Steel	Chrome Steel	80 X 1000 rpm
FR133zz	0.09375"	0.1875"	0.0937"	0.234"	0.031"	Shielded	Chrome Steel	Chrome Steel	80 X 1000 rpm
FR1-5	0.09375"	0.3125"	0.1094"	0.359"	0.023"	Open	Chrome Steel	Chrome Steel	60 X 1000 rpm
FR1-5 2rs	0.09375"	0.3125"	0.1406"	0.359"	0.031"	Sealed	Chrome Steel	Chrome Steel	60 X 1000 rpm
FR1-5zz	0.09375"	0.3125"	0.1406"	0.359"	0.031"	Shielded	Chrome Steel	Chrome Steel	60 X 1000 rpm
FR144	0.125"	0.25"	0.0937"	0.296"	0.023"	Open	Chrome Steel	Chrome Steel	67 X 1000 rpm
FR144 2rs	0.125"	0.25"	0.1094"	0.296"	0.031"	Sealed	Chrome Steel	Chrome Steel	67 X 1000 rpm
FR144zz	0.125"	0.25"	0.1094"	0.296"	0.031"	Shielded	Chrome Steel	Chrome Steel	67 X 1000 rpm
FR2-5	0.125"	0.3125"	0.1094"	0.359"	0.023"	Open	Chrome Steel	Chrome Steel	60 X 1000 rpm
FR2-5 2rs	0.125"	0.3125"	0.1406"	0.359"	0.031"	Sealed	Chrome Steel	Chrome Steel	60 X 1000 rpm
FR2-5zz	0.125"	0.3125"	0.1406"	0.359"	0.031"	Shielded	Chrome Steel	Chrome Steel	60 X 1000 rpm
FR2-6	0.125"	0.375"	0.1094"	0.422"	0.023"	Open	Chrome Steel	Chrome Steel	53 X 1000 rpm
FR2-6 2rs	0.125"	0.375"	0.1406"	0.422"	0.031"	Sealed	Chrome Steel	Chrome Steel	53 X 1000 rpm
FR2-6zz	0.125"	0.375"	0.1406"	0.422"	0.031"	Shielded	Chrome Steel	Chrome Steel	53 X 1000 rpm
FR2	0.125"	0.375"	0.1562"	0.44"	0.03"	Open	Chrome Steel	Chrome Steel	56 X 1000 rpm
FR2 2rs	0.125"	0.375"	0.1562"	0.44"	0.03"	Sealed	Chrome Steel	Chrome Steel	56 X 1000 rpm
FR2zz	0.125"	0.375"	0.1562"	0.44"	0.03"	Shielded	Chrome Steel	Chrome Steel	56 X 1000 rpm
FR155	0.15625"	0.3125"	0.1094"	0.359"	0.023"	Open	Chrome Steel	Chrome Steel	53 X 1000 rpm
FR155 2rs	0.15625"	0.3125"	0.125"	0.359"	0.036"	Sealed	Chrome Steel	Chrome Steel	53 X 1000 rpm
FR155zz	0.15625"	0.3125"	0.125"	0.359"	0.036"	Shielded	Chrome Steel	Chrome Steel	53 X 1000 rpm



FR Series Flanged Miniature Bearings

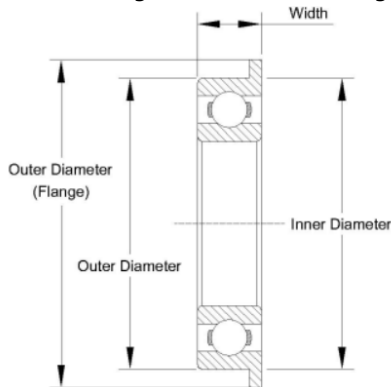

Part Number	Bore diameter	Outside diameter	Width	Flange outer diameter	Flange thickness	Seal type	Ring material	Ball material	Limiting speed
FR156	0.1875"	0.3125"	0.1094"	0.359"	0.023"	Open	Chrome Steel	Chrome Steel	53 X 1000 rpm
FR156 2rs	0.1875"	0.3125"	0.125"	0.359"	0.036"	Sealed	Chrome Steel	Chrome Steel	53 X 1000 rpm
FR156zz	0.1875"	0.3125"	0.125"	0.359"	0.036"	Shielded	Chrome Steel	Chrome Steel	53 X 1000 rpm
FR166	0.1875"	0.375"	0.125"	0.422"	0.023"	Open	Chrome Steel	Chrome Steel	50 X 1000 rpm
FR166 2rs	0.1875"	0.375"	0.125"	0.422"	0.031"	Sealed	Chrome Steel	Chrome Steel	50 X 1000 rpm
FR166zz	0.1875"	0.375"	0.125"	0.422"	0.031"	Shielded	Chrome Steel	Chrome Steel	50 X 1000 rpm
FR3	0.1875"	0.5"	0.156"	0.565"	0.042"	Open	Chrome Steel	Chrome Steel	43 X 1000 rpm
FR3 2rs	0.1875"	0.5"	0.196"	0.565"	0.042"	Sealed	Chrome Steel	Chrome Steel	43 X 1000 rpm
FR3zz	0.1875"	0.5"	0.196"	0.565"	0.042"	Shielded	Chrome Steel	Chrome Steel	43 X 1000 rpm
FR168	0.25"	0.375"	0.125"	0.422"	0.023"	Open	Chrome Steel	Chrome Steel	48 X 1000 rpm
FR168 2rs	0.25"	0.375"	0.125"	0.422"	0.036"	Sealed	Chrome Steel	Chrome Steel	48 X 1000 rpm
FR168zz	0.25"	0.375"	0.125"	0.422"	0.036"	Shielded	Chrome Steel	Chrome Steel	48 X 1000 rpm
FR188	0.25"	0.5"	0.125"	0.547"	0.023"	Open	Chrome Steel	Chrome Steel	40 X 1000 rpm
FR188 2rs	0.25"	0.5"	0.1875"	0.547"	0.045"	Sealed	Chrome Steel	Chrome Steel	40 X 1000 rpm
FR188zz	0.25"	0.5"	0.1875"	0.547"	0.045"	Shielded	Chrome Steel	Chrome Steel	40 X 1000 rpm
FR4	0.25"	0.625"	0.196"	0.69"	0.042"	Open	Chrome Steel	Chrome Steel	38 X 1000 rpm
FR4 2rs	0.25"	0.625"	0.196"	0.69"	0.042"	Sealed	Chrome Steel	Chrome Steel	38 X 1000 rpm
FR4zz	0.25"	0.625"	0.196"	0.69"	0.042"	Shielded	Chrome Steel	Chrome Steel	38 X 1000 rpm
FR1810	0.3125"	0.5"	0.1562"	0.547"	0.031"	Open	Chrome Steel	Chrome Steel	40 X 1000 rpm
FR1810 2rs	0.3125"	0.5"	0.1562"	0.547"	0.031"	Sealed	Chrome Steel	Chrome Steel	40 X 1000 rpm
FR1810zz	0.3125"	0.5"	0.1562"	0.547"	0.031"	Shielded	Chrome Steel	Chrome Steel	40 X 1000 rpm
FR6	0.375"	0.875"	0.2188"	0.965"	0.062"	Open	Chrome Steel	Chrome Steel	32 X 1000 rpm
FR6 2rs	0.375"	0.875"	0.2812"	0.965"	0.062"	Sealed	Chrome Steel	Chrome Steel	32 X 1000 rpm
FR6zz	0.375"	0.875"	0.2812"	0.965"	0.062"	Shielded	Chrome Steel	Chrome Steel	32 X 1000 rpm
FR8zz	0.5"	1.125"	0.3125"	1.225"	0.062"	Shielded	Chrome Steel	Chrome Steel	32 X 1000 rpm
FR10zz	0.625"	1.375"	0.3438"	1.5"	0.069"	Shielded	Chrome Steel	Chrome Steel	25 X 1000 rpm